



Vocational Education and Training

Pest Management Units of Competency and Certificate III in Pest Management

Enrolment Information and Form

2018

This Enrolment form was first compiled in March 2014 by:

PEST Australia Pty Ltd
85 Brown Street
East Perth WA 6008

First published: March 2014
Version No: 9.8
Release Date: February 2018

Important Notice on Use of Current Version:

Changes are made periodically to reflect the latest industry practices. Before commencing staff induction, you must ensure you are using the current version. To ensure you are complying with this requirement check with the Chief Executive Officer.

Version	Release Date	Authorisation	Comments
9.1	30 March 2014	Mark Sheppard	Primary release
9.2	25 July 2014	Mark Sheppard	Second release
9.3	12 January 2015	Mark Sheppard	Third release
9.4	25 July 2015	Mark Sheppard	Fourth release
9.5	29 July 2016	Mark Sheppard	Fifth release
9.6	26 May 2017	Mark Sheppard	Sixth release
9.7	29 September 2017	Mark Sheppard	Seventh release
9.8	5 February 2018	Mark Sheppard	Eighth release

Thank you for choosing to enrol on a course with Pest Education Services & Training (PEST). PEST is committed to high standards in the provision of vocational education and training (VET) programs in Pest Management. PEST is a Registered Training Organisation (RTO Code: 2514) with the Training Accreditation Council (TAC) in Western Australia. We comply with the Standards for Registered Training Organisations (RTO's) 2015 and comply with the Australian Qualifications Framework (AQF). We offer Nationally Recognised units of competence and the Certificate III in Urban Pest Management as specified on our Scope of Registration. This information is publically available at any time on www.training.gov.au

We are pleased to take part in your learning journey. Together we will aim for an outcome that provides the best experience possible to attain your learning goals. We will achieve this by both parties working together.

OUR COMMITMENT TO YOUR TRAINING AND ASSESSMENT

PEST is committed to providing quality training and assessment services. We are responsive to needs and continue to develop products and services to meet those diverse needs of clients by providing flexible learning opportunities. We achieve this by:

1. Providing training and assessment services that;
 - a. Are developed in consultation with industry
 - b. Meet the requirements of the Property Services Training Package, Pest Management Units of Competence and PEST's own training and assessment strategies.
2. Ensuring training and assessment is delivered by trainers and assessors who:
 - a. Have the necessary training and assessment competencies as determined by the Standards for RTO's 2015, and
 - b. Have the relevant vocational competencies at least to the level being delivered or assessed, and
 - c. Can demonstrate current industry skills directly relevant to the training/assessment being undertaken, and
 - d. Continue to develop VET knowledge and skills as well as their industry currency and trainer/assessor competence.
3. Delivery and assessment methods used meet specific quality requirements and are chosen to best suit the unit of competency, while giving full consideration to the learning style of the candidate. A number of delivery methods will be used throughout the training to help you achieve the necessary skills. Learning is a partnership that involves participation from all involved. Delivery methods will be outlined on the course information flyer.
4. PEST offers flexible delivery in various forms of delivery to accommodate the varying needs of candidates. Most current courses and all new courses are offered in a face-to-face environment, via correspondence, or Recognition of Prior Learning (RPL) or a combination of these.
5. Ensuring assessment including Recognition of Prior Learning (RPL):
 - a. Meets the requirements of the relevant Training Package or accredited course.
 - b. Is conducted in accordance with the principles of assessment and the rules of evidence.
 - c. Meets workplace and, where relevant, regulatory requirements.
 - d. Is systematically validated.

Recognition of Prior Learning (RPL)

Students who consider they already possess the competencies identified in all or part of any course/qualification offered by PEST may seek recognition. RPL is a method of assessing if you have evidence of competency for a particular unit of

competency that you are enrolled in. It is important to remember that RPL is an assessment process not an assumption of competence.

RPL is the determination, on an individual basis, of the competencies obtained by a client through previous formal training, work experience, and/or life experience. RPL therefore determines the consequent advanced standing to which the client is entitled in relation to a course/qualification. The main focus of RPL is what has been learned rather than how, where or when it was learned. RPL focuses on both the demonstration of competence and the currency of that competence to industry standards. Students wishing to undertake RPL should contact our office to obtain an application form.

National Recognition

PEST is committed to recognising the AQF qualifications and Statements of Attainment issued by other Registered Training Organisations (RTOs). National recognition comes into effect when a Statement of Attainment or qualification provided by a candidate has the same national competency codes as those that form part of the training and assessment program within which the candidate is enrolled or is intending to enrol. Students are required to formally apply for National Recognition. Students wishing to apply for National Recognition should contact our office to obtain an application form.

Client Needs

PEST establishes the needs of clients, and delivers services to meet these needs.

1. Licencing

All competency based training provided by PEST leads to licencing. The Department of Health, Western Australia, Pesticide Safety Section is responsible for all licencing of pesticide operators in Western Australia. On occasion the Department of Health will request, and we will supply information on Candidates enrolment status. Please advise us if you do not wish this to occur. For more information on courses for licencing please visit our website, www.pesteducation.com.au

2. Language, Literacy and Numeracy

PEST assesses the Language, Literacy and Numeracy (LLN) needs of all candidates and makes appropriate concessions for language, literacy and numeracy issues of clients where these concessions do not compromise the requirements of the relevant Training Package and the integrity, equity and fairness of assessment. Advice is given to all clients on the appropriate action if there is a need to update literacy and numeracy skills. PEST can assist in providing additional development prior to completing your enrolment.

CPSISC has used the Department of Industry's Workplace English Language and Literacy (WELL) Program to develop a number of Training Package resources to support learners who may require some assistance with language, literacy and numeracy (LLN). The aim of the WELL Program is to provide workers with English language, literacy and numeracy skills to meet their employment and training needs. Students who require more information should contact our CEO.

3. Special Needs

Students intending to enrol for training with PEST are requested to advise us if they have any physical or other impairment (e.g. English language, literacy or numeracy difficulties, dyslexia, etc) which may adversely affect their ability to successfully undertake training and assessment, prior to enrolment. Students with disabilities or impairments are encouraged to discuss with the CEO any 'special needs' and/or 'reasonable adjustments' to the study environment which they consider are necessary or would assist them in the performance of their studies. The CEO, in collaboration with the candidate, will assess the potential for the participant to successfully complete the training which may include flexible delivery options to optimise the ease and benefit of the participants learning.

Assessment

Assessment is an integral part of your learning if you wish to complete successfully and gain certification. PEST is committed to ensuring valid and reliable assessment of achievements as outlined in the Property Services Training Package. Throughout the training program you will be assessed to see if you have gained the necessary skills and knowledge to achieve the qualification. Your trainer/assessor is required to ensure that the assessment tasks you undertake meet the national principles of assessment and rules of evidence. Assessment methods will be outlined on the course information flyer.

Please note: Certificates and Statement of Attainment will only be awarded to those candidates who successfully complete all assessment requirements for a course.

Record Keeping

Pest Education Services & Training keeps complete and accurate records of the attendance and progress of clients, as well as financial records that reflect all payments and charges and the balance due, and provides copies of these records to clients on request. Candidates are required to keep a copy of all work submitted for assessment. No responsibility is taken for lost work.

Certificates

There are three types of certificates issued by PEST. Certificates can only be awarded in accordance with our approved scope.

1. Qualification

Issued under the Australian Qualification Framework (AQF) for nationally recognised training. This qualification is the Certificate III in Urban Pest Management.

2. Record of Results

Accompanies a qualification issued under the Australian Qualification Framework (AQF) for nationally recognised training. This document supplements the qualification listing all units of competency achieved.

3. Statement of Attainment (SOA)

Issued under the Australian Qualification Framework (AQF) for nationally recognised training. Issued when a client is deemed competent in specific units of competency but where not all units making up a full qualification have been achieved. Minimum achievement for a SOA is one unit of competency. You can request a SOA at any time during your training.

4. Authenticity of documents

All certificates are created and printed only once and are individually signed by the CEO. We do not copy, pdf or email certificates under any circumstances. If a certificate is lost, a client must complete Form C7-5 Certificate Request. Charges apply.

Certificates will only be posted to the person or entity that is nominated as financing the course at the nominated postal address, as advised in Section 8 of this enrolment form. The onus is on the candidate to ensure their address details are correct and current. Certificates will not be sent to other parties, without the expressed prior written permission from the financier.

Course Fees

PEST has developed a fair and equitable process for determining course cost, fee refunds and payment options. Course fees and other charges are outlined in the course information flyer. Once your enrolment has been accepted, the course is confirmed and at the commencement of the course, fees are payable. Where course fees exceed \$1,500, \$1,500 is due at the commencement of the course and the balance is due at the completion of the course. Payment may be made by cash, cheque or electronic funds transfer. Certificates are not released until payment is made in full. Additional fees may be charged for additional assessments if required.

Refund Policy

Clients have fourteen (14) days from the receipt of payment to apply for a refund. Applications must be made in writing stating the reasons for terminating the course. A full refund will apply to course materials if these are returned in the exact condition they were provided. No refund will be granted for materials that are damaged or marked. Only a portion of your training and assessment fees will be refunded. This amount will be determined once the hourly rate of \$195 plus GST is deducted for all work undertaken on your behalf. No refunds will be granted once a course has commenced. Should PEST be unable to complete training and assessment for any reason, a full refund will apply.

RTO Cancellation of courses

PEST reserves the right to cancel a scheduled course if insufficient enrolments are received prior to course commencement. In these cases, courses will not be confirmed and invoices for training will not be raised. Students already booked in these courses will be notified in writing.

Training Guarantee

Once a candidate has been enrolled on a course and commenced study in their chosen qualification or course, we then provide a guarantee to the candidate that they will be able to finish the course. If required, employers funding candidate training must make their own arrangements with regard to reimbursement of training costs with the individual

candidate should they leave their employment during or after training. Should additional services be required, an hourly rate of \$195 plus GST will apply.

Student Records

PEST maintains an individual candidate file for every candidate who undertakes any form of training and assessment with us. This file contains records regarding your personal details provided to us, any training and assessment undertaken and completed. This file is available to you.

In accordance with Privacy laws and confidentiality requirements, your file is kept in a secure electronic file. Those who can access your information include PEST personnel for training and assessment purposes and Auditors assigned by the TAC for quality auditing purposes. No other person/candidate can and will have access to your personal candidate file without your prior written permission. If you would like access to your personal records simply contact the CEO in writing at any time.

Privacy

PEST is bound by the Privacy Act and respects candidates, staff and trainers' right to privacy. Information is collected from candidates upon initial enquiry in order to send out course information, and is collected at enrolment and during the provision of the training and assessment services. PEST may use personal information to advise candidates of upcoming events and training course, for marketing and research purposes.

PEST collects, analyses and acts on relevant feedback on services provided through surveys is collected. This feedback assists us improve the quality of the services and training. This information is treated confidentially. PEST will only disclose information to other parties as stated above, or as otherwise allowed under the Privacy Act 1988. Our privacy statement may be revised from time to time and is available on our website; www.pesteducation.com.au

Student Complaints and Appeals

All candidates have the right to express a concern or problem they may be experiencing when undergoing training. PEST provides the appropriate mechanisms and services for learners to have complaints and appeals addressed efficiently and effectively. All complaints and appeals are recorded, acknowledged and dealt with fairly, efficiently and effectively.

If you have a complaint against the RTO, its trainers, assessors, other staff or another learner of the RTO, please notify the CEO, Mark Sheppard. Complaints will be handled according to the B2.1 Complaints Policy which is available in the reception area of our training room. A copy of this policy is available from the CEO at any time.

If you require a review of decisions, including assessment decisions, we will provide a referral to an appropriate third party where you can seek further assistance. Appeals will be handled according to the B2.2 Appeals Policy which is available in the reception area of our training room. A copy of this policy is available from the CEO at any time.

Legislation in Training

PEST monitors relevant legislation which impacts on all training programs. PEST includes information regarding legislation to candidates in their candidate manuals for a particular course. PEST maintains a healthy and effective learning environment for candidates by;

- Treating all persons with respect
- Displaying courtesy and consideration to all
- Treating all persons professionally, fairly and equally
- Acting with integrity

Located in the reception of our training room are PEST's policies relating to:

- Access and Equity
- Duty of Care
- Equal Opportunity
- Anti-discrimination
- Prevention of Harassment, Vilification and Bullying
- Sexual harassment
- Complaints and Appeals

Copies of these policies are available from the CEO.

Occupational Safety and Health (OSH)

PEST is committed to providing a safe and healthy learning and work environment. PEST encourages all persons to regard accident prevention and safety as a collective and individual responsibility.

PEST recognises its responsibility under the Occupational Safety and Health Act and related Regulations. The CEO has responsibility for ensuring the health and safety of staff, candidates, contractors and visitors. This includes:

- Provide and maintain safe plant, equipment and systems of work.
- Provide, monitor and maintain systems for safe use, handling, storage and transportation of plant, equipment and substances.
- Maintain the workplace in a safe and healthy condition.
- Provide adequate facilities to protect the welfare of all employees.
- Provide information, training and supervision for all staff and contractors, helping them to integrate OSH into their work areas and roles.
- Provide information, where relevant, to candidates, allowing them to learn in a safe and healthy manner.
- Check OSH system compliance via ongoing auditing.
- Integrate continuous improvement into OSH performance.

PEST's full Occupational Safety and Health Policy is located in the reception of our training room. A copy of this policy is available from the CEO at any time.

Duty of Care

Under Occupational Safety and Health legislation candidates have a duty of care to maintain a safe environment for both themselves and their fellow candidates. Should you be involved in an accident which results in personal injury and/or damage to equipment or facilities, notify your trainer immediately. If you have a personal health condition which may become critical while attending the course, please advise PEST so we can provide support or treatment should an emergency arise. Emergency procedures and exit plans must be followed. Please see the plan detailed in this document.

YOUR COMMITMENT TO YOUR TRAINING AND ASSESSMENT

Completing this Form

You are required to complete this form in full. You will be responsible for the accuracy of the information provided. If you are unable to do so, we may be unable to provide training to you.

Course Confirmation

Your course commences once your enrolment has been accepted and /or the course is confirmed. Course confirmation guidelines are provided on the course information flyer.

Unique Student Identifier (USI)

In 2012 Commonwealth, State and Territory governments agreed to introduce a Unique Student Identifier (USI) linked to the national VET data collection. This will provide candidates will access to and control over their future training records and help streamline data exchange between candidates, training providers and other relevant stakeholders. All candidates must obtain a USI when enrolling after 1 October 2014. You only need to apply once in your lifetime. Your USI statement must be provided to us before we can issue a statement of attainment or qualification. For more information please visit:
<http://www.usi.gov.au/Pages/default.aspx>

Payment of Fees

Payment for the course (fees) is required at the commencement of the course. An invoice will be raised once the course is confirmed and your payment is required on the day of commencing. Please do not pay on enrolment. If you are registering an expression of interest, an invoice will be raised once the course date and your attendance are confirmed in writing.

Government Funding

You may qualify for government training entitlements and subsidy arrangements in relation to the delivery of our services. It is up to the individual candidate to assess if this arrangement suits their needs. PEST will provide assistance to those wanting to know more about government training entitlements and subsidy arrangements

Training Details

All classroom training is conducted at our purpose built training room located at:

85 Brown Street,
East Perth WA 6008

Please see locality and parking map at the end of this document.

Our normal office hours are 8.30am to 5pm unless otherwise stated on the information flyer provided for the course.

Your trainer and assessor contact details are:

Mark Sheppard

Office: 9255 7007

Mobile: 0412 442 265

Email: mark@pesteducation.com.au

Change of personal details

If during the course of study, you change your name or your address, you are required to notify PEST in writing as soon as possible.

Dress and Hygiene

- Neat, comfortable clothing is considered appropriate for training in a classroom environment at PEST.
- Appropriate footwear must be worn at all times.
- You will be working in close proximity with others, therefore, care with your personal hygiene (clothing, hair, deodorant etc) is required.
- You must wear personal protective clothing and equipment as required for onsite training.

Mobile Phones

All phones must be turned off during the training course, as a courtesy to the Trainer and other candidates. Mobile calls can be retrieved during breaks. In an emergency where you need to be contacted, please advise your trainer so that arrangements can be made.

Duty of Care

You have a duty to:

- Protect your own health and safety and to avoid adversely affecting the health and safety of any other person.
- Not wilfully or recklessly interfere or misuse anything provided by PEST.
- Cooperate with health and safety directives given by PEST and its staff.
- Ensure that you are not affected by the consumption of drugs or alcohol.

Respect for others

It is expected that the behaviour of all persons in the learning environment ensure a positive learning experience. Respect for other candidates and trainer is expected. Students are expected to behave in a professional manner at all times, taking others into consideration. Student discipline will be enforced where candidate are acting inappropriately, behaving in a manner which disrupts training or in a manner deemed to be dangerous to others.

- You are required to respect the rights of others and treat others in a manner which is fair and non-discriminatory
- No derogatory or prejudicial comments are acceptable with reference to a person's culture, disability, ages, gender, sexuality, or religion as prescribed in Equal Opportunity and Discrimination laws.
- Harassment, bullying and intimidation of staff or fellow candidates will not be tolerated
- Inappropriate language and actions will not be tolerated
- Treat facilities and equipment with due care and respect

Equal Opportunity

As a candidate at PEST, you have the responsibility to:

- Act to prevent harassment, discrimination and victimization against others.
- Respect differences among other staff, candidates and contractors, such as cultural and social diversity.
- Treat people fairly, without discrimination, harassment or victimization.
- Refuse to join in with these behaviours.
- Supporting the person in saying no to these behaviours.

- Acting as a witness if the person being harassed decides to lodge a complaint.

Student Discipline

PEST may implement candidate discipline processes which may include:

- Suspension from the training room or onsite training session
- Expulsion from the training room or onsite training session
- Expulsion from the Training Course

Security

Do not leave handbags or other valuables unattended. Although building may be reasonably secure, you are ultimately responsible for your own belongings. PEST accepts no responsibility for any belongings which may be stolen or go missing.

Student Attendance

Student attendance is recorded on your Student Attendance Record. These records are required for learning and OSH reasons. Student attendance in class is paramount to successful completion of learning and assessment outcomes. Students are expected to be in attendance for all training sessions.

You are required to arrive to class on time and stay for the full duration of the class. Should it be necessary to leave a class early, you must advise the trainer before the class commences. If you are absent from class, it is your responsibility to catch up on work missed. If you are going to be absent from a scheduled class or activity, please advise your trainer. Additional fees may be incurred.

Punctuality

As a courtesy to other candidate and the trainer, all candidates must be punctual both at the start of the day and when returning from breaks. Punctuality is essential to avoid disruption to other candidates and the trainer.

Assessment

All assessment items must be submitted as directed by your trainer and assessor. If you are posting in your assessments, always keep a copy of these as we take no responsibility for mail lost by Australia Post. If you are unable to retrieve your work you will be required to complete it again. All assessments must be submitted within twelve (12) months of the course commencement date. If you are having difficulty

completing an assessment item, you should discuss it with your trainer as soon as possible. This way the trainer may be able to offer support or grant additional time. Please note that the Training Package is being continually improved and replaced. Should you be unable to complete the course within the time allocated we may not be able to issue a statement of attainment or qualification for the course you have enrolled in if there is a change in the training package and the superseded packaged is removed from our scope. In accordance with our Training Guarantee, we will advise you of any changes.

If your course assessment involves a face to face / interview assessment component, the course fee only covers one interview. Interview assessments are only scheduled once a Candidate has completed all course training and assessments they advise us they are adequately prepared for the assessment. Candidates who arrange an interview assessment and are not adequately prepared and deemed not yet competent may incur additional fees for subsequent assessments.

Mentor

All applicants are required to choose a mentor. Your mentor will play an important part in gaining your qualification. The person you choose must be a fully licenced pest management technician with a minimum of two (2) years' experience. Your mentor must be someone who can provide quality support; guidance and advice in the workplace to assist you reach your educational goals. If you do not have a mentor, one will be assigned to you.

Replacement of Qualifications

Candidates must complete Form C7-5 Certificate Request stating the reasons for the request. A certificate reissue fee of \$55 will apply.

Evaluation and Feedback

PEST is required to collect feedback under the AQTF Quality Indicators and has developed feedback forms for you to provide feedback at the end of this course.

PEST values all feedback from candidates as it assists us to continuously improve the products and services we offer. Students are encouraged to provide us with feedback, both positive and constructive. Should you wish to provide additional feedback, feedback forms and a feedback box is located at reception.

Pest Education Services and Training Locality and Parking Map

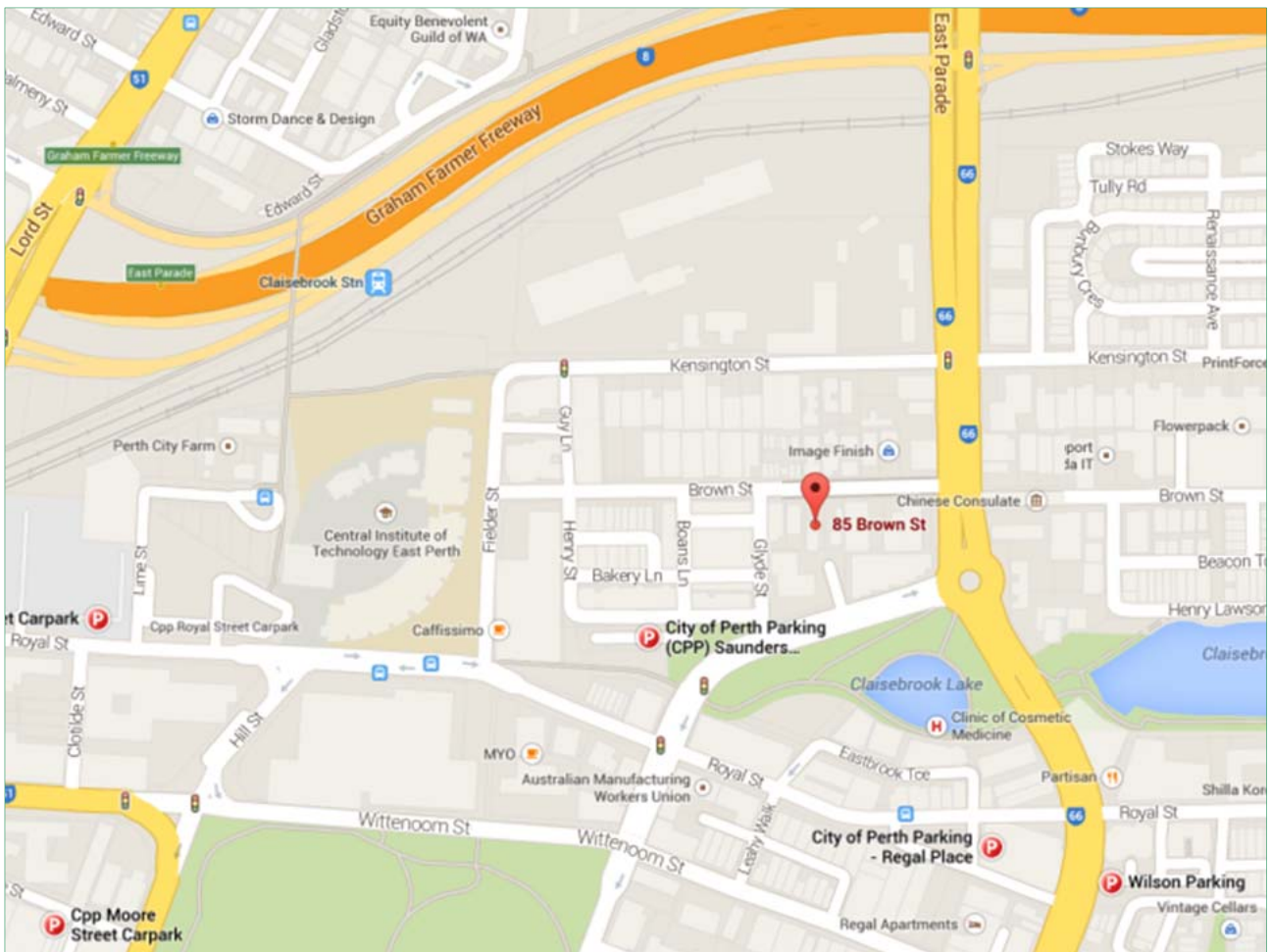

Pest Education Services and Training Site Evacuation Map

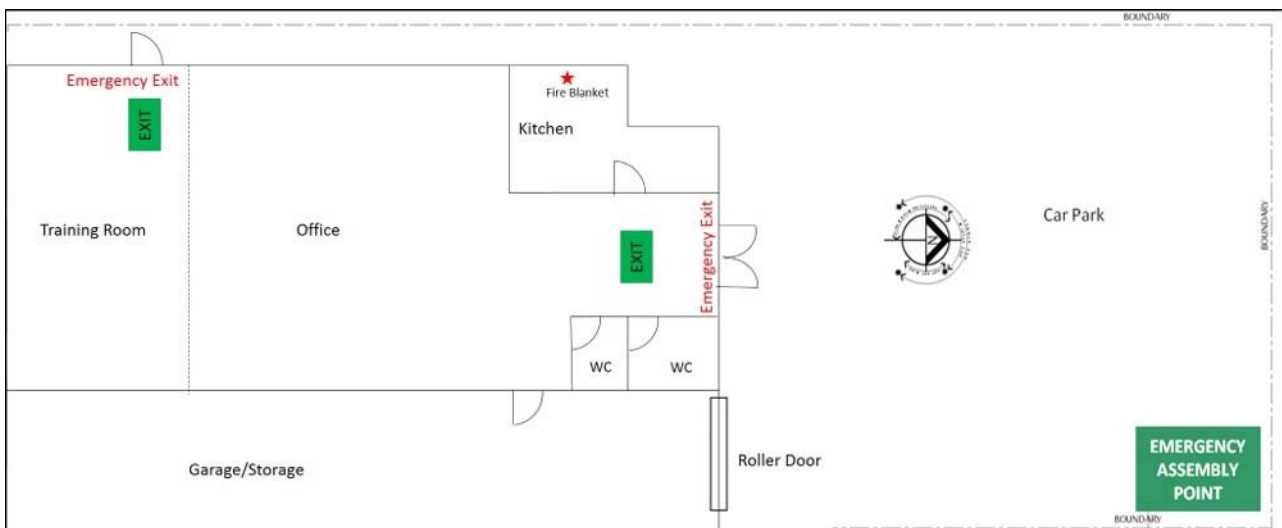

INSTRUCTIONS:

Exit the building by the nearest exit. Walk. Do not run. Close, but do not lock, doors and windows if safe to do so to contain the fire. Proceed to the emergency assembly point if safe to do so. Ensure the driveway is not blocked. Contact Emergency Service by telephoning 000. Do not attempt to use fire extinguishers or put out the fire unless you have received specific training. Do not re-enter the building until given the "All Clear" by Emergency Services.

TRAINING ENROLMENT FORM

Fill in all sections clearly and carefully by writing in block letters.

Information requested on this form is for national database and tracking purposes and assists in ongoing qualification issuance as required. All data is confidential and is not forwarded to any other party with the sole exception of the national statistical database to comply with the Total Vet Activity reporting for RTOs. Please write clearly and accurately as errors may incur additional administration fees.

1 COURSE DETAILS

Course/Qualification Title:

Date of enrolment:

Training Agreement No. (Traineeships Only)

Delivery Mode: Classroom Distance RPL Traineeship Online

2 PERSONAL AND EMPLOYER DETAILS

Title: (Please tick) Mr Mrs Miss Ms Dr Other

Surname:
(As you would like shown on your certificate)

Given Names:
(As you would like shown on your certificate)

Preferred Name:

Date of Birth (Day/Month/Year)

Gender (Tick one box only) Male Female

Unique Student Identifier (USI)

NOTE: Please attach or forward a copy of your USI confirmation with this enrolment form. You will need to apply for a Unique Student Identifier prior to the commencement of the course if you do not have one. Please visit the following webpage on how to apply.
<http://www.usi.gov.au/Pages/default.aspx>

Contact Details:

Home Telephone:

Work Telephone:

Mobile:

Home Email:

Work Email:

Emergency Contact Details:

Emergency Contact Name:

Relationship:

Telephone:

Residential Address: *(Please provide your usual place of residence)*

Flat/Unit details:

Street Number and Name:

Suburb/Locality/Town:

State/Territory:

Postcode:

Postal Address: *(If different from the above)*

Flat/Unit details:

Street Number and Name:

Postal Delivery Information: *(i.e. PO Box)*

Suburb/Locality/Town:

State/Territory:

Postcode:

Employer details:

Company Name:

Contact Name: *(Owner or Supervisor)*

Street Number and Name:

Postal Delivery Information: *(i.e. PO Box)*

Suburb/Locality/Town:

State/Territory:

Postcode:

3 LANGUAGE AND CULTURAL DIVERSITY

Are you of aboriginal or Torres Strait Islander origin?

(For persons of both Aboriginal AND Torres Strait Islander origin, mark both "Yes" boxes)

- No
- Yes, Aboriginal
- Yes, Torres Strait Islander

Were you born in Australia?

- Yes
- No, please specify country of birth below:

Do you speak a language other than English at home?

- No, English only *(Go to disability section)*
- Yes, other – please specify below:

How well do you speak English?

- Very Well Well Not well Not at all

4 DISABILITY

Do you consider yourself to have a disability, impairment or long term condition?

- No *(Go to education section)*
- Yes

If you indicated the presence of a disability, impairment or long term condition, please select the area(s) in the following list: *(You may indicate more than one area)*

- | | | |
|---------------------------------------|--|--|
| <input type="checkbox"/> Hearing/Deaf | <input type="checkbox"/> Physical | <input type="checkbox"/> Intellectual |
| <input type="checkbox"/> Learning | <input type="checkbox"/> Mental Illness | <input type="checkbox"/> Acquired Brain Impairment |
| <input type="checkbox"/> Vision | <input type="checkbox"/> Medical Condition | <input type="checkbox"/> Other |

5 EDUCATION

What is your highest completed school level?

- | | |
|--|--|
| <input type="checkbox"/> Year 12 or equivalent | <input type="checkbox"/> Year 9 or equivalent |
| <input type="checkbox"/> Year 11 or equivalent | <input type="checkbox"/> Year 8 or below |
| <input type="checkbox"/> Year 10 or equivalent | <input type="checkbox"/> Never attended school |

In which year did you complete that school level?

Are you still attending secondary school?

- Yes
- No

Have you successfully completed any of the following qualifications?

<input type="checkbox"/> Yes <i>(please tick ANY applicable boxes)</i>	<input type="checkbox"/> No <i>(Go to the Employment section)</i>
<input type="checkbox"/> Bachelor Degree or Higher Degree	<input type="checkbox"/> Certificate III (or Trade Certificate)
<input type="checkbox"/> Advanced Diploma or Associate Degree	<input type="checkbox"/> Certificate II
<input type="checkbox"/> Diploma (or Associate Diploma)	<input type="checkbox"/> Certificate I
<input type="checkbox"/> Certificate IV (or Advanced Certificate/Technician)	<input type="checkbox"/> Certificates other than the above

6 EMPLOYMENT

Of the following categories, which best describes your current employment status? *(Tick ONE box only)*

<input type="checkbox"/> Full-time employee	<input type="checkbox"/> Employed – unpaid worker in a family business
<input type="checkbox"/> Part-time employee	<input type="checkbox"/> Unemployed – seeking full-time work
<input type="checkbox"/> Self employed – not employing others	<input type="checkbox"/> Unemployed – seeking part-time work
<input type="checkbox"/> Employer	<input type="checkbox"/> Not employed – not seeking employment

7 STUDY REASON

Of the following categories, which best describes your main reason for undertaking this course/traineeship /apprenticeship? *(Tick ONE box only)*

<input type="checkbox"/> To get a job	<input type="checkbox"/> It was a requirement of my job
<input type="checkbox"/> To develop my existing business	<input type="checkbox"/> I wanted extra skills for my job
<input type="checkbox"/> To start my own business	<input type="checkbox"/> To get into another course of study
<input type="checkbox"/> To try for a different career	<input type="checkbox"/> For personal interest or self development
<input type="checkbox"/> To get a better job or promotion	<input type="checkbox"/> Other reasons

8 FEES AND PAYMENT

PLEASE NOTE: Certificates will be sent to the person or entity that finances the course unless prior written approval is provided by the undersigned to redirect the certificate to another person or address. Certificates are not released until payment is received in full.

Invoice details:

Company Name:	<input type="text"/>
Contact Name: <i>(Owner or Supervisor)</i>	<input type="text"/>
Street Number and Name:	<input type="text"/>
Postal Delivery Information: <i>(i.e. PO Box)</i>	<input type="text"/>
Suburb/Locality/Town:	<input type="text"/>
State/Territory:	<input type="text"/>
Postcode:	<input type="text"/>

Contact Details:

Work Telephone:

Mobile:

Work Email:

Fee:

Method of payment:

(Please do not pay on registration. An invoice will be issued when the course is confirmed. Payment is required before or on the day of commencing the course)

Cash

Cheque

Electronic Funds Transfer (EFT)

9 MENTOR

I have chosen a fully licenced pest management technician as my Mentor

No

Yes, please specify details below:

Mentor Name:

Pest Management Licence Number:

10 EMAIL UPDATES

I would like to subscribe to email updates.

(Email addresses are kept in accordance with our privacy policy. Candidates can unsubscribe to email updates at any time.)

Yes

No

11 NATIONAL RECOGNITION

I would like to apply for National Recognition

(Please attach your statement of attainment to this form)

Yes

No

12 RECOGNISED PRIOR LEARNING

I would like to apply for recognised prior learning

(If yes, candidates will be contacted by an assessor)

Yes

No

13 DECLARATION

I understand that information contained in these forms may be provided to State and Commonwealth agencies and research organisations and I consent to that occurring. I certify that all details provided on these forms are correct.

Candidate Name:

Signed:

Date:

RTO Representative:

Signed:

Date:

OFFICE USE ONLY

PAYMENT PLAN DETAILS:

Invoice Date:

Amount:

Date Received:

Invoice Date:

Amount:

Date Received:

RTO Representative:

Signed:

Date: